



# ROBUST STEEL BUILDING TECHNOLOGY LTD.

A Pre-Engineered Steel Building Manufacturer

# TABLE OF CONTENTS

Contents	Page No.
About Robust Steel Building Technology Ltd.	02
Message from managing director	03
Company Information	04
History of philosophy	05
Mission & Vision	06
Why Robust Steel	07
Advantage of steel structures	08-10
Our Business Scope	11-12
Design Code Material Specifications	13-22
Steel Building System	23-24
Accessories	25-26
Production Line	27
Projects Information Plan	28
Handover Projects	29-40
Ongoing Projects	41-42
Some of our Valuable Clients	43
Our Legal Papers	44-48

## About ROBUST STEEL

### ***“Robust Steel Building Technology Ltd.”***

As a Pre Engineered Steel Building Manufacturer, we focus on meeting the needs of our nationwide clients for durable, affordable and versatile steel structures. Since 2018, from starting of business, our clients remain in our first priority. Every building that we design, manufacture, and deliver for erection is created with the satisfaction of the future occupants and owners in mind. As a company, we attribute our success to the unmatched value of our products and the flexibility and agility of our employees in meeting the needs of our clients.



# MESSAGE FROM MANAGING DIRECTOR

---

**Assalamu Alaikum Wa Rahamatullah**

Dear Valued Clients.

To Face the challenge of twenty first century you must have to ensure the best use of your time. In this era time is money Robust Steel building technology Ltd. started its journey from 2018 to ensure its client's best use of time by supplying the product in-time.

**Latest Design Concept:**

We believe that design should be a reflection of clients desire in a sustainable way. We follow latest design code with all rules & regulations. Our Design team dedicated to provide you the best design considering projects purpose.

**Best quality raw materials:**

We source best quality raw materials & accessories for steel building from china, Tiwan , Japan. Before delivery we do pre shipment inspection (PSI) by the third party for over sure about quality, we also do necessary test from BUET before start manufacturing steel building members.

**Professionalism practice:**

We ensure that all of our worker and staff are well trained and they are aware about their duties, responsibilities & ethics. They knows the risk of their job & how to minimize the risk at work site. Personal protective equipment (PPE) must have to wear when they are in duty.

**After sales service :**

Clients is our assets, we always believe that clients satisfaction is most important for any business. So after hand-over a project we provide any kinds of supportive service at free of cost in warranty period.

So we are cordially inviting you to take our services for your any kinds of pre engineered steel structure & be satisfied with our quality products and services in time.

Thanking you



**Engr. Md. Mohin Uddin**

B. Sc. Engg.(Civil)

**Managing Director**

Robust Steel Building Technology Ltd.

## COMPANY INFORMATION

Name of the company	: <b>Robust Steel Building Technology Ltd.</b>
Corporate Office	: House 24 (Flat: A-3), Block-B, Road-01, Niketan, Gulshan-01, Dhaka-1212.
Registered Office	: 55/B, Noakhali Tower, Purana Paltan, Dhaka-1000.
Cell	: +88 01773-421 821, 01858-444 666
E-mail	: robuststeel.bd@gmail.com
Website	: www.robuststeelbd.com
Web Mail	: info@robuststeelbd.com
Registration No	: C-154765/2019
Tin Certificate No.	: 165016373933
Trade License No	: 238372/2019
Principal Bankers	: City Bank Ltd.
Branch	: Islami Banking Branch.
Factory Area	: 45,000 Sft.
Factory Address	: Shaha Beliswar, Bathuli, Dhamrai, Dhaka.
Production Capacity	: 15,000 MT/Year
Field of Activities	: Design, Shop Detail, Fabrication, Supply & Erection of Pre-Engineered Steel Buildings, RCC Construction & Road Construction.
Managing Director	: Engr. Md. Mohin Uddin



## HISTORY & PHILOSOPHY

“Robust Steel Building Technology Ltd”. is a Pre-Engineered Steel Building manufacturer company in Bangladesh and has immense experience in all type of structural design, fabrications, supplies and erection of Pre-Fabrication steel structure and civil construction works since 2018.

The Company has undertaken many challenging projects and accumulated skills, know-how and experiences in design and building solutions, project management services, building trades and related engineering works.

Today, “Robust Steel” takes on the role of main contractor for small to medium size projects and performs project management services to co-ordinates specialist trades for industrial/commercial projects. We also provide design inputs and engineering solutions as value added services to our clients.

Our objective is to provide our clients with an “I am assured” experience when we are chosen to execute their projects. Our emphasis on clear communication and follow through procedures ensures that client’s objectives are top priority in the planning and execution of all our processes.

Our project management and execution philosophy is:

- Create detail schedule and resources plan to meet client's project objective
- Communicate clearly with all project stakeholders
- Track project progress and fine tune deviations
- Supervise closely on quality of work done
- Complete and commission the project on time

We take pride in our delivery, thus our clients can always be assured that only the most experienced and qualified people are serving them, all the time.

# *MISSION*

To provide the best steel building products and services to our clients. Our client will get a one-top solution for Design, Fabrication and Erection of any kinds of steel structure from us with best quality and satisfaction.

# *VISION*

To be the country-wide most reliable and innovative manufacturer, Service and solution provider in the steel industry.

# *MOTTO*

We build best structure.... For your stronger future...

# Why Robust Steel ?

## *One Stop Solutions :*

A complete Service package consist of single responsibility for consulting, planning, design, fabrication, supply and erection we are providing for steel structures.

## *Quality Assurenccec :*

we use a quality materials for steel structures these are completely comply with the relevant mill certification and test report. We always ensure safe and economy design for our clients.

## *Worthy:*

In order to be a complete service package “Robust Steel” always offer a competitive and cost effective price to its valuable clients.

## *Design Flexibility:*

We always offer design flexibility to our clients that the architectural plan can adapted to any kind of future expansions of structure.



## ADVANTAGES OF STEEL STRUCTURE:

### *Value of Money:*

Steel Framing System including decking & Fire protection will typically cost 5% to 7% less than a concrete framing system.

### *Aesthetic Appeal:*

Can be bent and rolled to create no-linear members to further enhance the aesthetic appeal of the structure.

### *Speed:*

Enhances construction productivity because of its shop fabrication while maintaining tight construction tolerances.

### *High Strength:*

Has a yield stress of 50,000psi in both compression and tension.



## ADVANTAGES OF STEEL STRUCTURE:

### *Sustainable:*

Structural steel is made of 88% recycled product, is fully recyclable in the future and can be reused without further processing.

### *Modifiable:*

Buildings can be modified in the future for new applications. Loading conditions, vertical or horizontal expansions and changes in owner desires in ways that other framing systems can never accomplish.

### *Efficient:*

Typical steel column occupies 75% less floor space than an equivalent concrete column and it also allows longer spans that eliminate intermediate columns creating open floor areas.

### *Reliable and Predictable:*

Structural steel is manufactured and fabricated under controlled conditions and the material is verified at the point of production.



### *Seismic Resistant*

Since Steel has a long-rang flexibility properties, so Steel Structure is more seismic resistant than RCC Building. Seismic resistance in steel structures is a critical consideration in regions prone to earthquakes. The aim is to design buildings that can withstand seismic forces without significant damage or collapse

### *Environment Friendly*

Steel structures are considered environmentally friendly for several reasons:

**Recyclability:** Steel is highly recyclable, with a recovery rate of around 90% for structural steel. It can be reused without loss of quality.

**Durability:** Steel structures have a long lifespan and require minimal maintenance, reducing the need for frequent repairs and replacements, which conserves resources and energy.

**Efficiency:** Steel structures are typically lighter than concrete, leading to less material usage and reduced transportation emissions. They also allow for quicker construction times, reducing on-site energy consumption.

**Resource Conservation:** The production of steel can be energy-intensive, but modern advancements have made it possible to use less energy and fewer raw materials.

**Adaptability:** Steel structures can be easily modified or expanded, promoting reuse and reducing waste associated with demolition and new construction.

**Reduced Environmental Impact:** Compared to traditional materials like wood, steel construction avoids deforestation and preserves natural habitants.

# OUR BUSINESS SCOPE:



Industrial Building



Multi-storied Steel Building



Industrial Shed



Garments Factory



Warehouse



Showrooms



Filling Station



Commercial Building



Textile Mills



Shopping Malls



Spinning Mills



Auto Rice Mills

# OUR BUSINESS SCOPE:



Auto Brick Field



Sports Stadium



Bridges



Power Station



Refinery



Rack Structures



Shipyards



Aircraft Hangar



Residential Building

## ALL TYPES OF STEEL STRUCTURAL WORKS

# DESIGN CODE

The Building are designed in accounting with the following codes:

Bangladesh National Building Code (BNBC-2020)  
International Building Code "IBC-2006".  
Metal Building Manufacturers Association (MBMA)  
Metal Building Systems Manual (MBSM) 2006  
ASCE-7-05 Minimum Design Loads for Buildings and  
others structures Edition: 2005  
American Society of Civil Engineers (ASCE)

Built up sections and Hot Rolled sections are Designed in  
accordance with:

Manual of Steel Construction-Allowable Stress Design (ASD) 1989  
American Institute of Steel Construction , Inc. (AISC) Manual of  
Steel Construction-Load Reduction Factor Design (LRFD).  
American Institute of Steel Constriction, Inc. (AISC)

Structural Analysis, Design and Detailing is done by the aid of  
following softwares:

STAAD Pro V8i, ETABS Non-Linear 2021 ,  
SAP-2010, STAAD Foundation 5.0,  
AUTO CAD-2024,SAFE12.1.1,Tekla Structures 17.0

Cold formed members are designed in accordance with:

2002 Edition of Cold Formed Steel design Manual American Iron  
and Steel Institute (AISl)

Welding is applied in accordance with:

American Welding Society (AWS D. 1.1-04)

# MATERIAL SPECIFICATIONS

## M.S Plate

Parameter		Min.mm	Max. mm
Flange	Width(B)	100	600
	Thickness (tf)	6	40
Web	Height-(H)	100	1500
	Thickness (tw)	6	100

**Material** : Hot Rolled Plates  
**Standard** : ASTM A572 M Grade-50 (G-345)  
**Yield Strength** : 345MPa  
**Surface** : Red Oxide/Gray Oxide  
**Length** : 6m  
**Application** : Column, Beam, Rafter, Bracing etc.



## H-Beam Section

Material	Build up Section
Standard	ASTM A572 M Grade-50 (G-345)
Yield Strength	345 MPa
Ultimate Strength	450 MPa



**Hot Rolled Strip**  
(by Gas Cutting or Shear Cutting)



**H-beam assembling**  
(by auto Spot Welding)

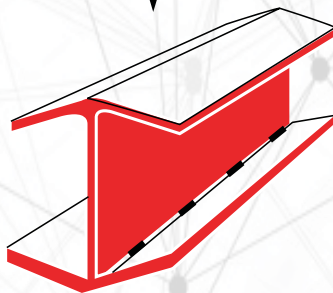

**H-beam Fabrication straighten**  
(by submerge arc welding)

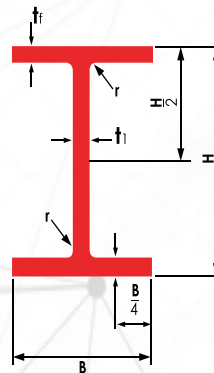

Geometrical moment of inertia  
 Radius of gyration of area  
 Modulus of section  
 (A = sectional area)

$$I = Ar^2$$

$$r = \sqrt{I/A}$$

$$Z = I/Y$$



# MATERIAL SPECIFICATIONS

## Cee & Zed Section

CEE & ZED Sections used as purlins or girt in three structural configuration

- a. As simple spans for both Cee & Zed Sections.
- b. As double spans for both Cee & Zed Sections continuous over the centre support.
- c. As continuous spans limited to Zed section lapped over each internal support

Base Steel	Cold Rolled Steel
Standard	ASTM A607 Grade 50
Yield Strength	345 Mpa
Tensile Strength	450 MPa

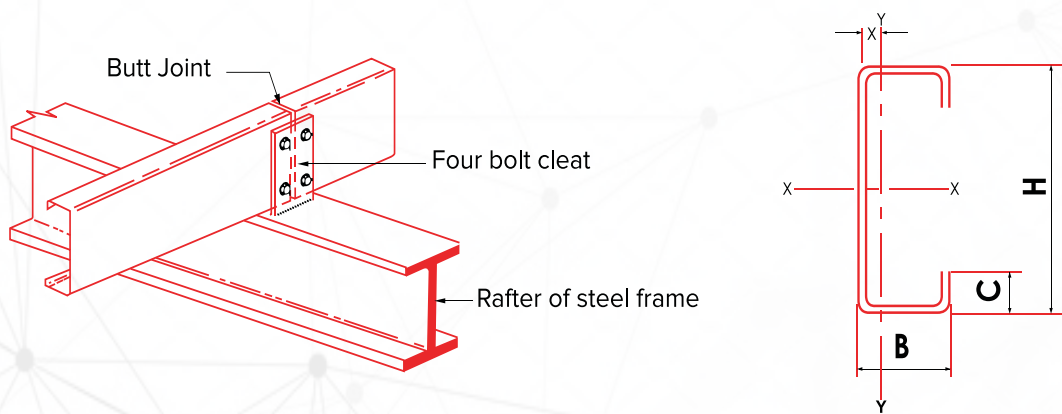

Fig: Cee Section

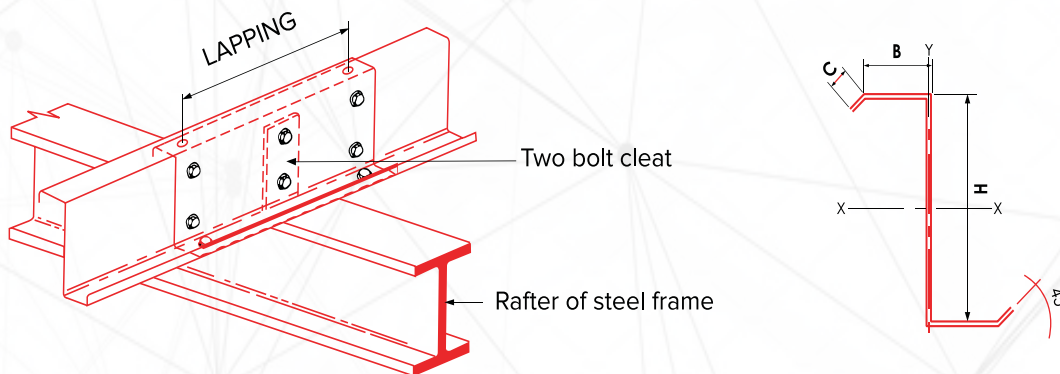

Fig: Zed Section

# MATERIAL SPECIFICATIONS

## Profile Panel

Aztec Gold GS-001	Ash Gray GS-002	Charcoal Grey trim only GS-003	Koko Brown trim only GS-004
Hawaiian Blue GS-005	Crimson Red trim only GS-006	Burnished Slate GS-007	Fern Green GS-008
Colony Green trim only GS-009	Rustic Red GS-010	Light Stone GS-011	Deep Grey GS-015
Gallery Blue trim only GS-013	Saddle Tan GS-014	Polar White GS-012	White GS-016

PHYSICAL PROPERTIES	PANEL -205		PANEL-190		ROOF TILES-202	
Feeder width	1000mm(39.37")	1220mm(48.00")	940mm(37.00")	1170mm(46.00")	1000mm (39.37")	1220mm (48.00")
Effective width	820mm(32.28")	1025mm(40.35")	760mm(29.92")	950mm(37.40")	808mm(31.81")	1010mm (39.76")
Total Coated Thickness(TCT)	0.47mm	0.47mm	0.47mm	0.47mm	0.47mm	0.47mm
Mass per unit area	4.32kg/m <sup>2</sup>	4.26kg/m <sup>2</sup>	4.35kg/m <sup>2</sup>	4.28kg/m <sup>2</sup>	4.51kg/m <sup>2</sup>	4.43kg/m <sup>2</sup>
Coverage	232 m <sup>2</sup> /MT	235 m <sup>2</sup> /MT	230 m <sup>2</sup> /MT	234 m <sup>2</sup> /MT	222 m <sup>2</sup> /MT	226m <sup>2</sup> /MT
Profile	Single Skin Trapezoidal					
Fastener	#12-16x50mm, Hex-Head Self-Drilling or Self-Tapping Screw depending on support thickness					

Base Steel	Cold Rolled Steel (.42mm BMT)
Standard	AS 1397-1993 Grade80(G550)
Yield Strength	550 MPa
Pre-Treatment	Proprietary Corrosion Converting Coating
Substrate	Aluminium-Zinc alloy Coating AZ-150 (150 g/ m <sup>2</sup> ) or depending on the product . Aluminium (55%), Zinc (43.4%)
Paint System	Primer Coating-Epoxy Primer Finish Coating-Polyvinylidene Fluoride(PVDF)
Profile	Single Skin Trapezoidal
Fastener	#12-16x50mm, Hex-Head Self-Drilling or Self-Tapping Screw depending on support thickness

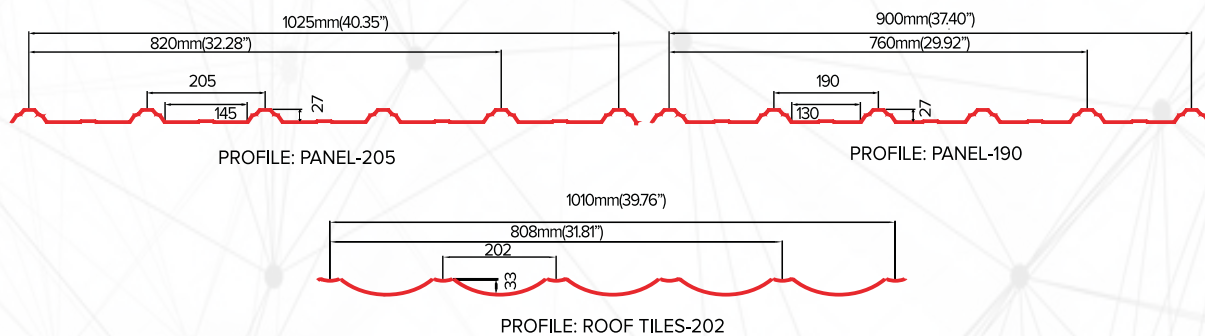

# MATERIAL SPECIFICATIONS

## Decking Panel

Base Steel	Cold Rolled Steel
Standard	JIS G3322 CGCC or A792(M)-01 a SS Grade 50(345)
Yield Strength	345 MPa
Tensile Strength	450 Mpa
Substrate	The metal coating vary from Z-200 (200g/m <sup>2</sup> ) to Z-450 (450g/m <sup>2</sup> )
Profile	Single Skin Trapezoidal
Profile Specification	YX52-238-715
Fastener	No.12-24x30mm, Hex-Headed Self-Drilling Screw or depending on support condition

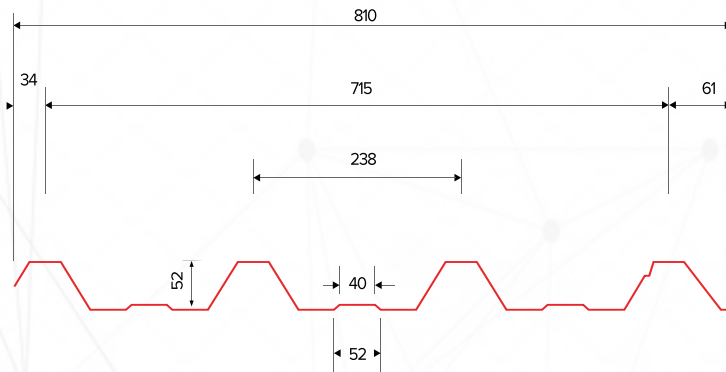

PHYSICAL & SECTION PROPERTIES	STANDARD		
Thickness, BMT mm [Gauge]	1.00[19]	0.75[21 ~ 22]	0.60 [23]
Mass per unit area, kg/m <sup>2</sup> [kg/sft]	11.31[1.05]	8.43 [0.78]	6.76 [0.63]
Coverage, m <sup>2</sup> /MT [sft/MT]	88.44[952]	118.64 [1,277]	147.90 [1,592]
Section Modulus, Zx [10 <sup>3</sup> mm <sup>3</sup> /m]	8.32	10.44	13.91
Cross-Sectional area, Ash[mm <sup>2</sup> /m]	839	1,049	1,399
Second moment of area, Ix [10 <sup>4</sup> mm <sup>4</sup> /m]	31.97	40.07	53.43



# MATERIAL SPECIFICATIONS

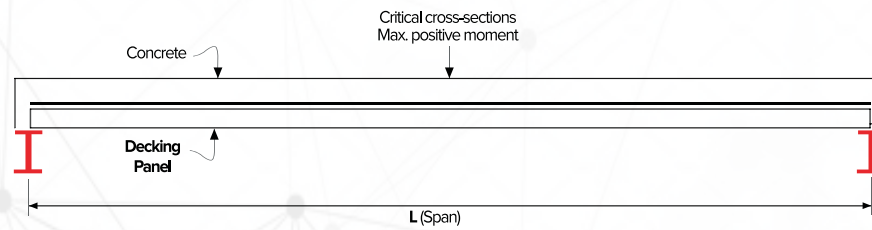
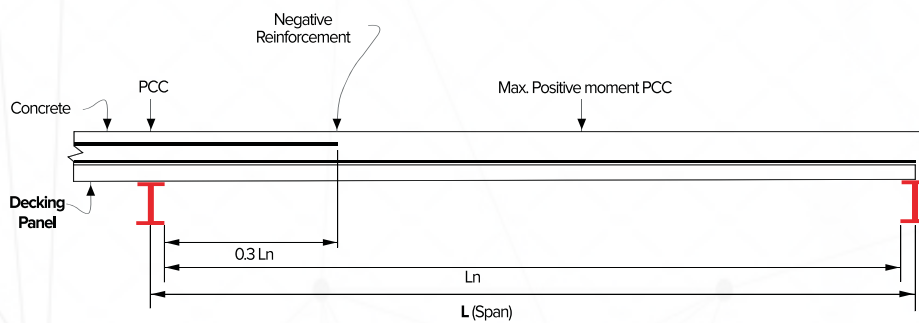
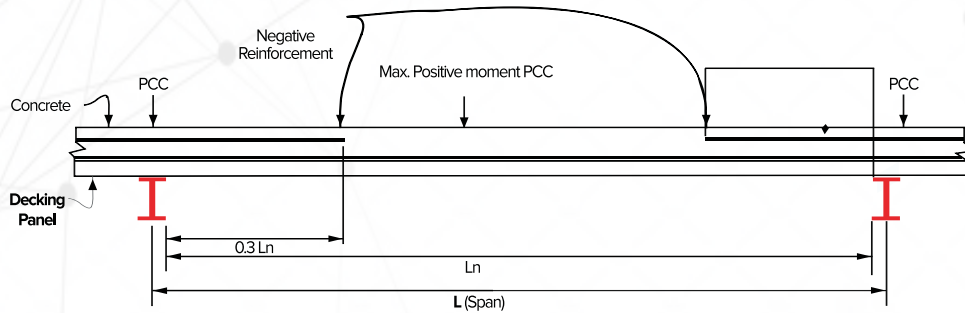

PCC: Potentially Critical Cross-Sections  
 FIG: Conventional Reinforcement

## Anchor Bolt

Bolt Dia (mm)	Weight/pc (kg)	A (mm)	B (mm)	C (mm)	Total Length (Tolerance= $\pm 25$ mm)	Tension (Kip)	Pull Out (Kip)	Description (mmxmm)
16	0.84	380	70	100	450	4.62	5.41	AB16x450
20	1.55	460	90	125	550	7.56	8.88	AB20x550
25	3.25	660	90	125	750	10.54	11.03	AB25x725
30	6.20	875	125	150	1000	17.02	16.88	AB30x1000

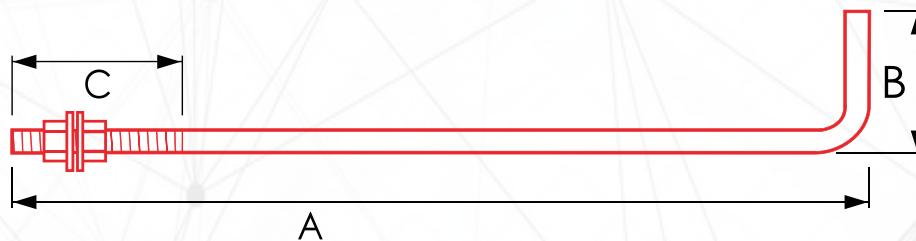

# MATERIAL SPECIFICATIONS

## Self-Drilling Fastener

Fasteners are sundry parts used to fasten side laps of wall and roof sheeting and for attaching trims or flashing. Roof Panel must be crest fixed to supports. On the other hand, profile sheet for wall can be crest fixed or vally fixed

Upport Thickness, Steel	Fastner	Application
	#12-16x25mm	Wall
Up to 4.5mm	#12-16x50mm	Roof & Wall
	#12-16x65mm	With insulation Blanket
	#12-24x25mm	Wall
Exceed 4.5mm	#12-24x50mm	Roof & Wall
	#12-24x65mm	With insulation Blanket

## Ridge Ventilator

Ridge Ventilator will provide natural air circulation at ridge line in any pre-engineered steel building. Ventilator can be installed as continuous or single unit considering throat opening 300mm to 600mm

Type	zrv-300, zrv-450 & zrv-600
Structure	Ridge Frame (cold-formed channels)
	Vent Girt (Cee or Zed Channel)
	Wind Band (Cold-formed 0.47mm pre-painted panel)
Main Parts	Top Plate, Throat Flashing End Flashin
	(All 0.47mm Pre-painted steel)
	Bird Screen (12mm x 12mm opening galvanized mesh)

## Translucent Panel

Translucent panels are used to provide additional light in any pre-engineered building. It may used at roof panel as well as panel respective to the steel profile shape.

Base Materials	Thickness	Length	Color	Profile
UV-Ray Resistant Plastic Resin Reinforcement by Mesh	1.5mm-3.0mm	Max .6100mm	Std. transparent red, blue & green	S-profile Panel-190 Panel-205

## Louver

Louver are used to provide natural air flow into a building. There are two type of louver, (i.e fixed louver & adjustable louver)

### Capacity

Thickness	0.35mm-1.5mm
Width	400mm-3050mm
Surface	Pre-painted color steel, Galvanized steel & Red Oxide Painted steel

## Structural Bolts

Structural bolts are used to fasten structural steel connection. Structural bolts should have one bolt, one nut & two washer.

M12x60mm, M12x65, M14x60, M14x65,  
M16x60, M16x65, M16x80,  
M18x60, M18x65, M18x80, M18x100,  
M20x65, M20x80, M20x100, M22x100, M24x100 etc.

# MATERIAL SPECIFICATIONS

## Sag Rod



SAG-ROD DETAIL (with four nut & four washers)

Shipmark	Length (mm)	Weight/PC (kg)	Purlin or girt distance (mm)	
			Minimum	Maximum
SR 1200	1200	0.81	1060	1140
SR 1350	1350	0.90	1210	1290
SR 1500	1500	1.00	1360	1440

## Capping, Flashings & Gutter System (Approx)

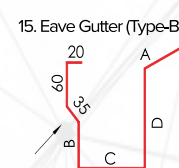
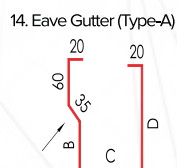
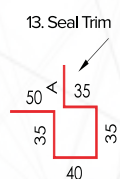
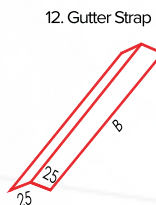
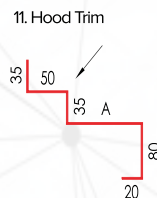
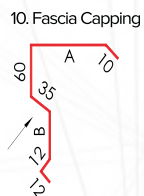
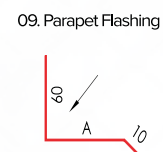
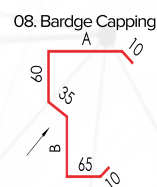
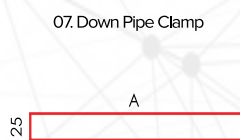
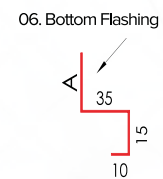
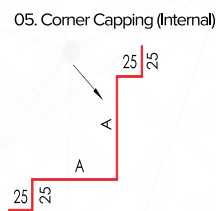
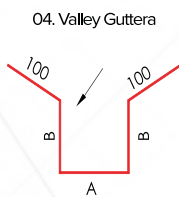
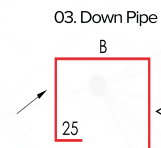
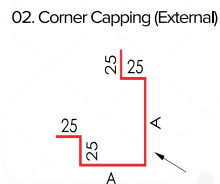
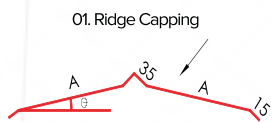

# MATERIAL SPECIFICATIONS

## Crane Systems

Robust steel structures can be designed to support any required crane system. Scope of Supply usually limited to the supply of column and rafter brackets, Crane runway beams and bracings. Runway beam can be done in both rolled and welded section.

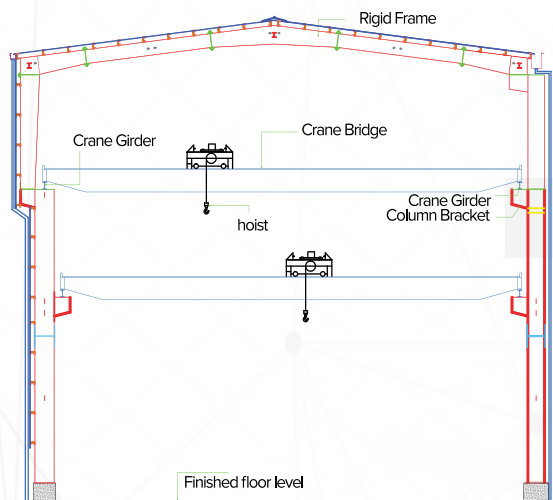

**Top Running Crane**

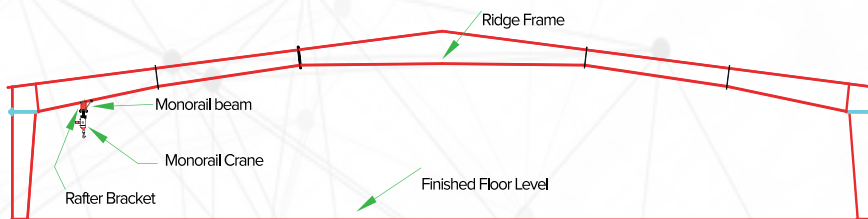

**Monorail Crane**

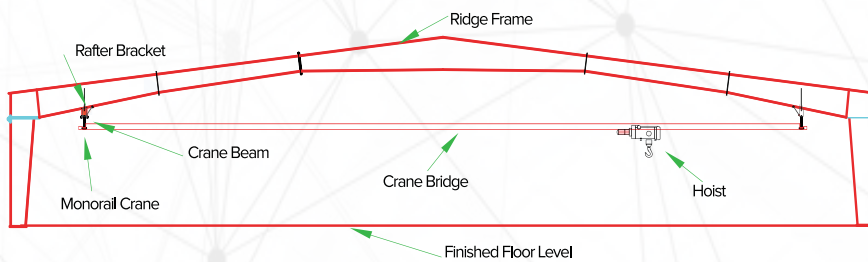

**Underhung Crane**

# MATERIAL SPECIFICATIONS

## Mezzanines

Standard mezzanine floor system consists of intermediate support columns, main beams, joist and a deck. The main beams will be supported by intermediate columns when it will be required by design loads. The economy of a mezzanine system depends on applied loads (dead, live and collateral) and mezzanine column spacing. Multi-level mezzanines, interior equipment platforms, catwalks and staircase can be accommodated if required as per complete given design data.

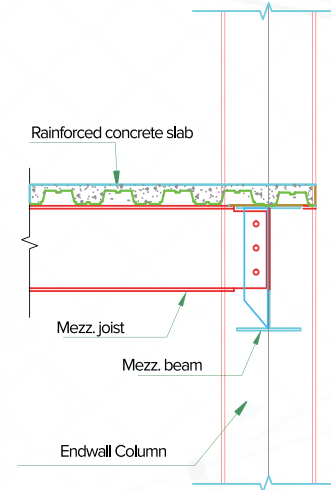

**Joist Connection to endwall column**

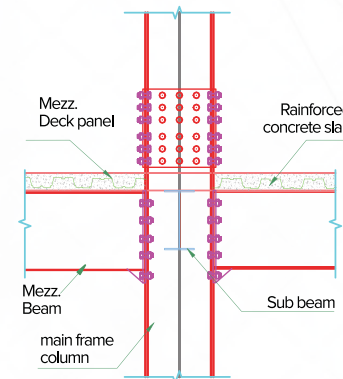

**Mezz. column beam connection**

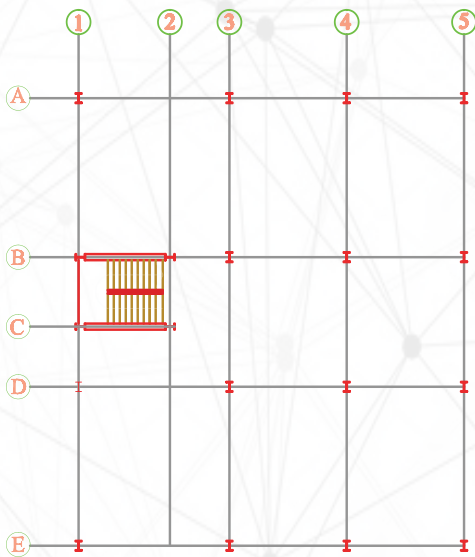

**Mezzanine Floor Column Layout Plan**

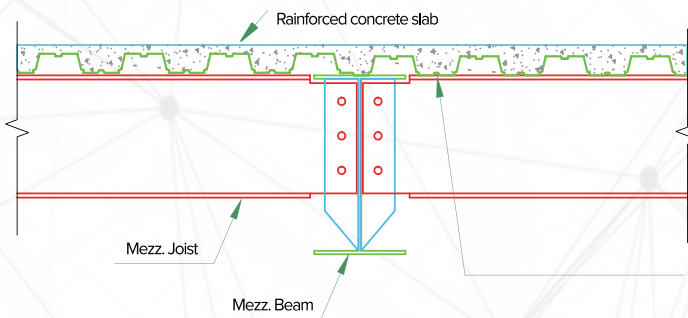

**Mezz. Joist Connection to Mezz. beam**

# STEEL BUILDING SYSTEM

## The Pre-engineered Steel Structure

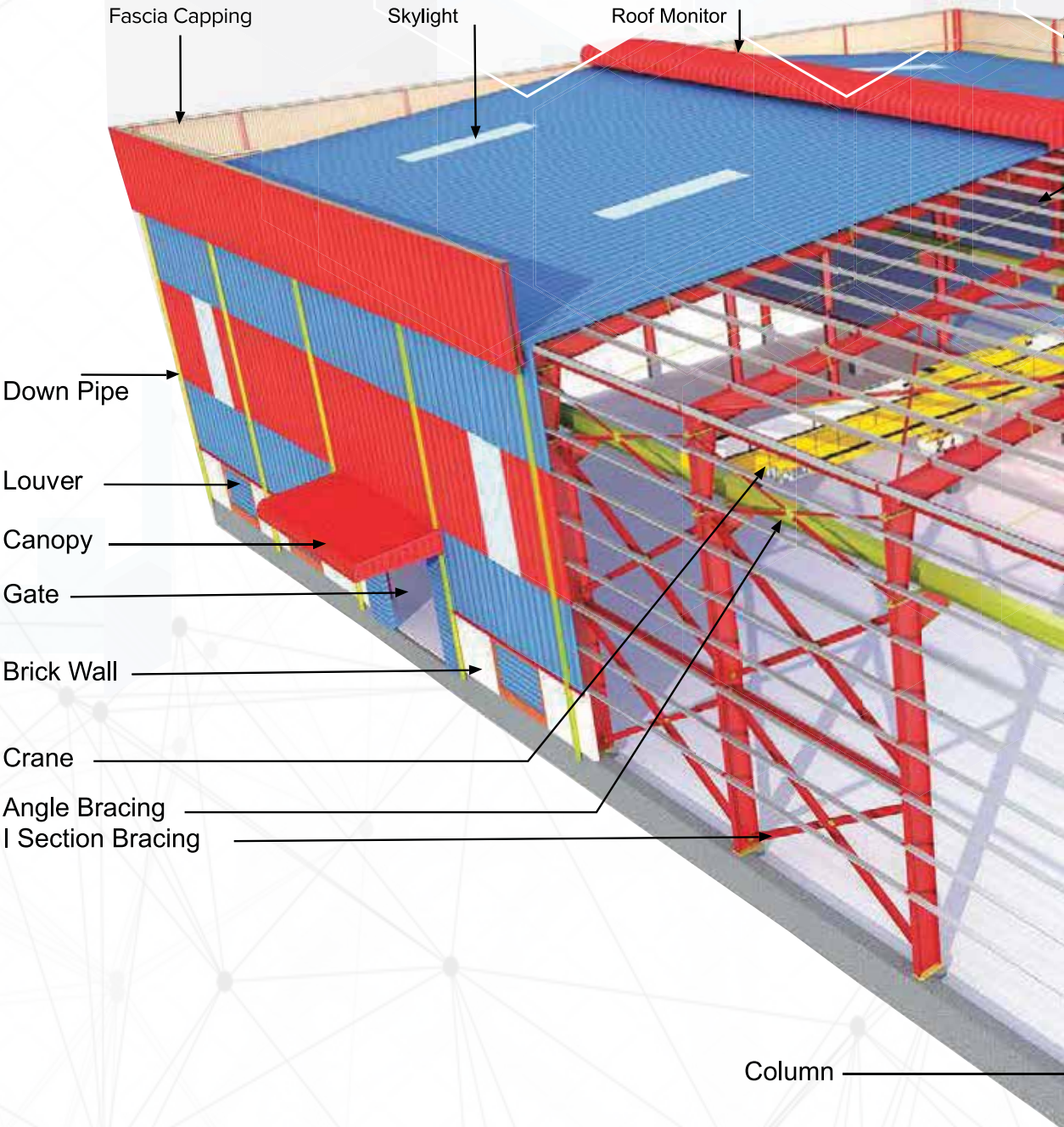

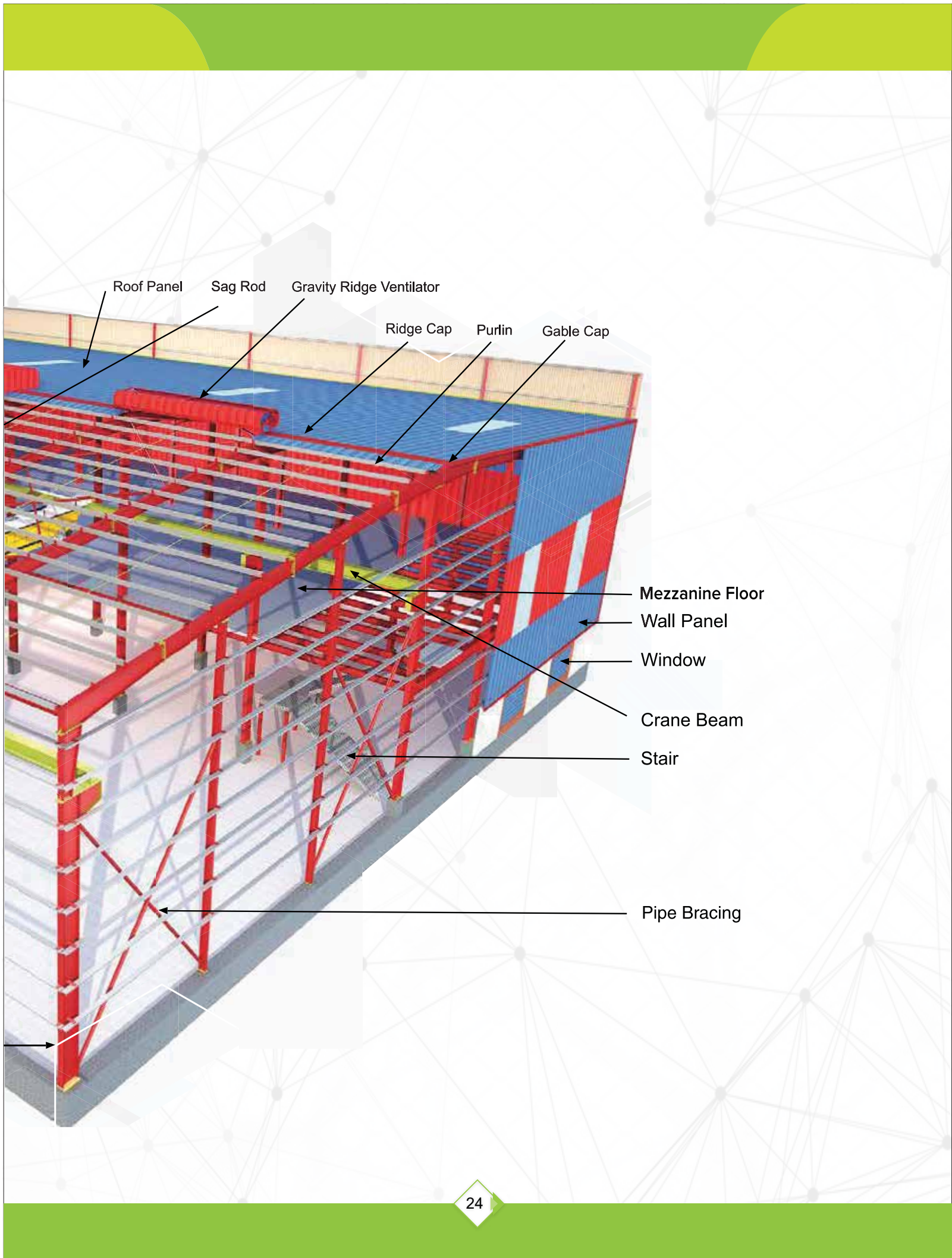

# ACCESSORIES



Anchor Bolts



Coil



Color-Coated Sheet-Coil

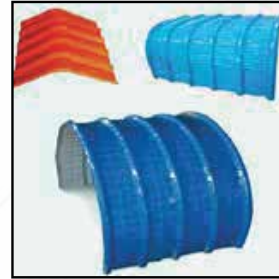

Curved Sheet



Checker Plate



C Purlin

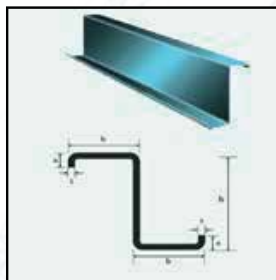

Z Purlin



Nut Bolts



Fasteners



Royal Bolts

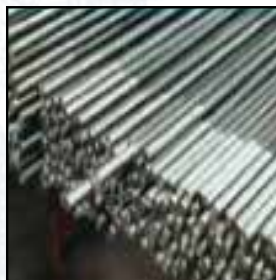

Sag Rod



Washer



Decoiling System



Fascia Capping



Down Pipe



Decking Panel

# ACCESSORIES



**Gravity Ventilator**



**Gutter**



**Louvers**



**Natural Ventilator**

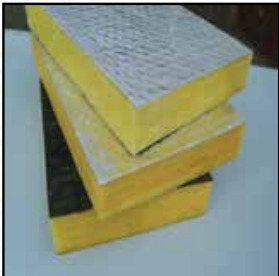

**Sandwich Panel**



**Glass Wool**



**Buble Insulation**

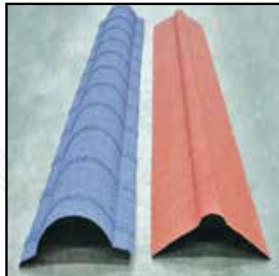

**Ridge Panel**

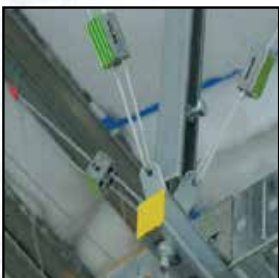

**Cable Bracing**

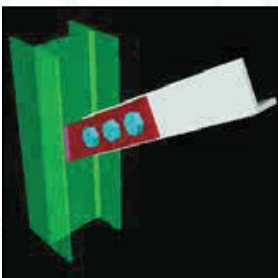

**Bracing Cleat**

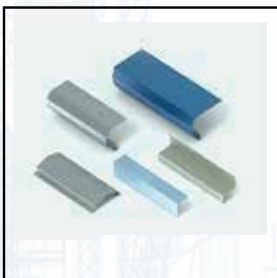

**Sliding Door**

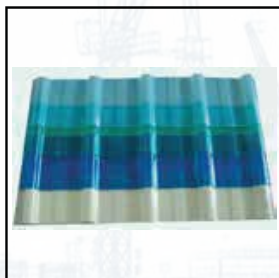

**Translucent Sheet**



**Silicon Sealant**



**Turn-Buckle**



**Stair**



**Sky Light**

## PRODUCTION LINE:

We continually strive to find the latest methods, technology and machines to ensure the highest levels of productivity, quality and delivery. We continually upgrade and invest in new equipment to ensure customer satisfaction. We are one of the best steel structures manufacturing facilities provider in Bangladesh. It is housed in an area of 45,000 square feet. Daily Production Capacity is 6 MT (Maximum).



Plate Shear Cutting Machine

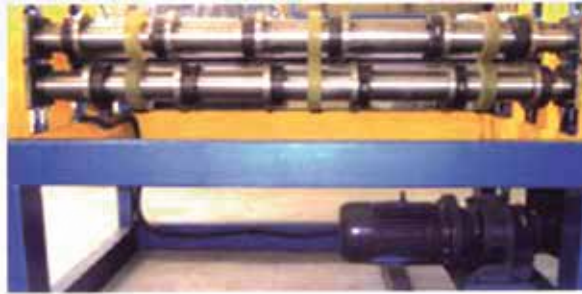

Slitting Machine



Beam Assembling Machine



Roll Forming Machine for C & Z



Mig Welding Machine



Roof & Wall Profile Sheet Forming Machine



Decoiler Machine



Deck Forming Machine

## RSBTL NEW PROJECT IMPLIMENTATION PLAN

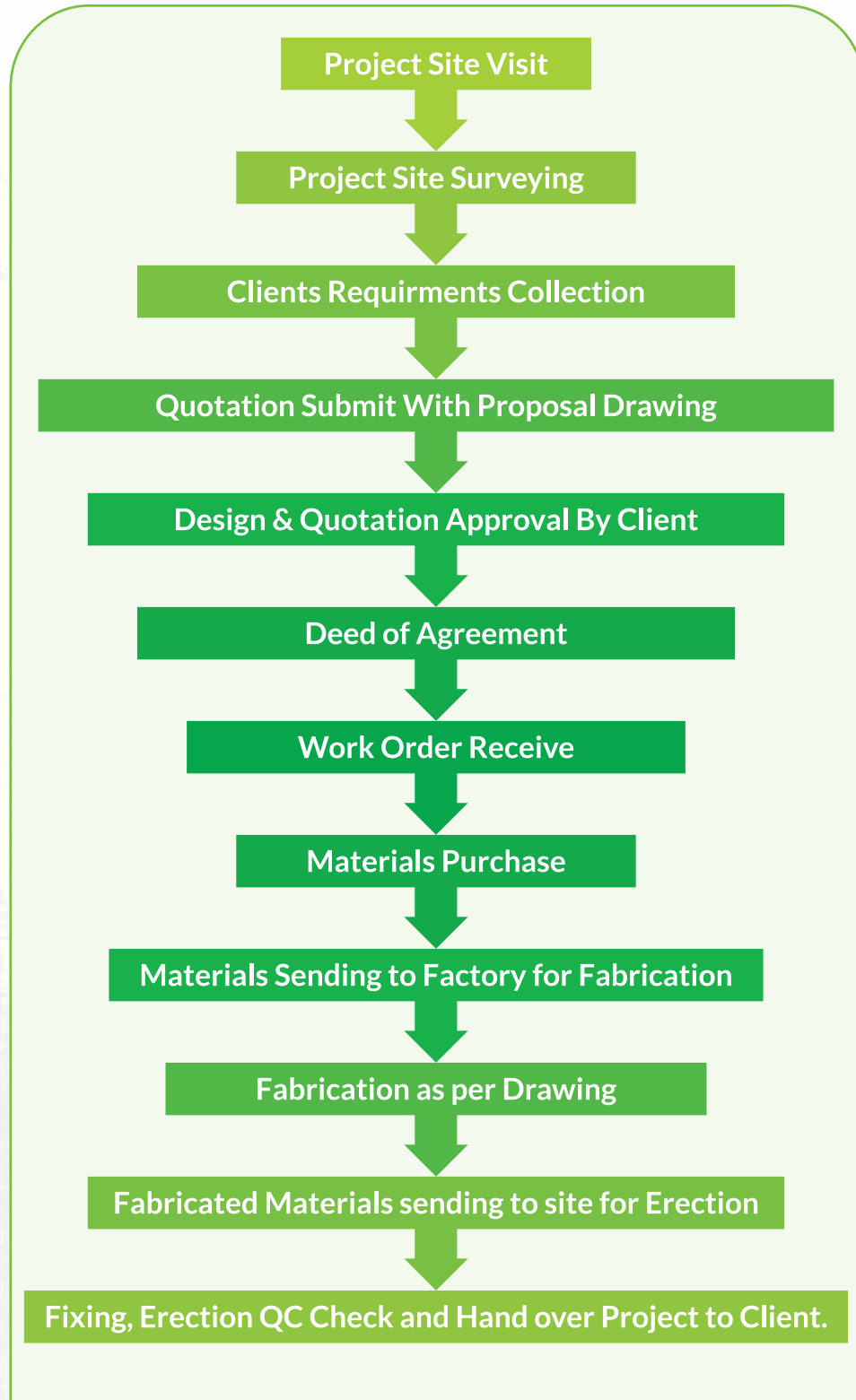

## HANDOVER PROJECT:

Client Name : Vivo Phone Factory  
Project Type : 6-Storeied Factory Building  
Project Location : Kushabo, Gawsia, Narayanganj  
Project area : 32,000 sft x 6 Storied

01



Client Name : Smart Technology (BD) Ltd.  
Project Type : 5-Storeied Utility Building  
Project Location : Kaliakoir, Gazipur  
Project area : 5,000 sft x 5 Storied

02



## HANDOVER PROJECT:

Client Name : APS Apparels Ltd  
Project Type : 4- Storied Dyeing Building  
Project Location : Mirer Bazar, Tongi, Gazipur  
Project area : 20,000 sft x 4 Storied

03



Client Name : BSB Global Network  
Project Type : Saleha Khatun Dakhil Madrasa  
Project Location : Akhaura, Brahmonbaria  
Project area : 12,000 sft x 6 Storied

04



## HANDOVER PROJECT:

Client Name : Steel Kings Ltd.  
Project Type : Single Storied Factory Shed  
Project Location : Kunia, Targacha, Gazipur  
Project area : 40,000 sft

05



Client Name : Audi Service Ltd  
Project Type : Single Storied Shed  
Project Location : Tejgaon, Dhaka  
Project area : 5,000 sft

06



## HANDOVER PROJECT:

Client Name : Audi Service Ltd  
Project Type : Charging Hub  
Project Location : Tejgaon, Dhaka  
Project area : 3,000 sft

07



Client Name : Smart Technology (BD) Ltd.  
Project Type : Single storied Badminton shed  
Project Location : Shewrapara, Mirpur  
Project area : 3500 sft

08



## HANDOVER PROJECT:

Client Name : CW Resources  
Project Type : Sea Beach Restaurant  
Project Location : Marine Drive Road, Inani, Cox's Bazar  
Project area : 15,450 sft

09



Client Name : HAMS Garments Ltd.  
Project Type : Single Storied Dyeing Shed  
Project Location : Masterbari, Gazipur  
Project area : 32,000 sft

10



## HANDOVER PROJECT:

Client Name : Henry Opt-Fibre Ltd.  
Project Type : Single Storied Factory Shed  
Project Location : Sirajganj  
Project area : 22,000 sft

11



Client Name : Japan Tobacco International  
Project Type : Roof Sheet Changing Work  
Project Location : Manikganj  
Project area : 72,000 sft

12



## HANDOVER PROJECT:

Client Name : Sinohydro Corporation  
Project Type : Aggregate Storage of Batching Plant Shed  
Project Location : Matarbari, Mohes Khali, Cox's Bazar  
Project area : 12,000 sft

13



Client Name : Dhaka Mass Transit Company Ltd.  
Project Type : Single Storied Warehouse  
Project Location : Diabari, Uttara, Dhaka  
Project area : 7,000 sft

14



## HANDOVER PROJECT:

Client Name : Robin Printing & Packages Ltd.  
Project Type : 2-Storeyed Factory Shed  
Project Location : Gazipur  
Project area : 20,000 sft

15



Client Name : Bangladesh Army-17 ECB  
Project Type : Rubber Fendering & Pier Protection  
Project Location : Dhaleshwari Bridge, Keraniganj, Dhaka

16



## HANDOVER PROJECT:

Client Name : Vertex Group  
Project Type : Roof Top Shed  
Project Location : Chader Bari, Munshiganj  
Project area : 32,500 sft x 2 Storied

17



Client Name : Windy Terrace Hotel  
Project Type : 12-Storeyed Building's Lift core  
Project Location : Chittagong

18



## HANDOVER PROJECT:

Client Name : The Peninsula Ctg Ltd.  
Project Type : 2-Storeyed MEP Building  
Project Location : Chittagong  
Project area : 18,000 sft x 2 Storeyed

19



Client Name : Smart Dairy Ltd.  
Project Type : Single Storeyed Milk Processing Shed  
Project Location : Vulta, Gawsia, Narayanganj  
Project area : 8,500 sft

20



## HANDOVER PROJECT:

Client Name : Smart Dairy Ltd.  
Project Type : Single Storied Cow Shed  
Project Location : Vulta, Gawsia, Narayanganj  
Project area : 20,000 sft

21



Client Name : Smart Technology (BD) Ltd.  
Project Type : Connecting Bridge  
Project Location : Vulta, Gawsia, Narayanganj

22



## HANDOVER PROJECT:

Client Name : Smart Technology (BD) Ltd.  
Project Type : Fire Exit Stair  
Project Location : Vulta, Gawsia, Narayanganj

23



Client Name : Blue Star School (Bangladesh Air Force)  
Project Type : Roof Top Work  
Project Location : Tejgaon, Dhaka  
Project area : 5,000 sft

24



## ONGOING PROJECT

Client Name : Smart Technology (BD) Ltd.  
Project Type : 8-Storeyed Factory Building  
Project Location : Kaliakoir, Gazipur  
Project area : 60,000 sft x 8 Storied

1



Client Name : Euro Marbel Ltd.  
Project Type : Single Storied Factory Shed  
Project Location : Dohar, Dhaka  
Project area : 25,600 sft

2



## ONGOING PROJECT

Client Name : Nitol-Niloy Group  
Project Type : 2-Storeyed Office Building & Filling Station  
Project Location : Raiganj, Sirajganj  
Project area : 10,500 sft

3



Client Name : Baitul Jannat Jame Masjid  
Project Type : 4-Storeyed Building  
Project Location : Hajiganj, Chandpur  
Project area : 5,000 sft x 4 Storeyed

4



Some of our Valuable Clients:



## OUR LEGAL PAPERS:



### Certificate of Incorporation (under Act XVIII of 1994)

No. C-154765/2019

I hereby certify that *Robust Steel Building Technology Limited* is this day incorporated under the Companies Act (Act XVIII) of 1994 and that the Company is Limited.

Given under my hand at *Dhaka* this *Third* day of *September two thousand and nineteen*.

By order of  
Registrar



Assistant Registrar  
Registrar of Joint Stock Companies & Firms  
Bangladesh

# ঢাকা দক্ষিণ সিটি কর্পোরেশন

www.dsc.gov.bd



লাইসেন্স ইস্যুর বিবরণ

ই-ট্রেড লাইসেন্স

ইস্যুর তারিখ : 24/07/2023  
ইস্যুর সময় : 16:04:27

লাইসেন্স নং : TRAD/DSCC/238372/2019

স্থানীয় সরকার (সিটি কর্পোরেশন) আইন, ২০০৯ (২০০৯ সনের ৬০ নং আইন) এর ধারা ৮৬- ৩৬ প্রদত্ত ক্ষমতাবলে সরকার প্রণীত আদর্শ কর তফসিল, ২০১৬ এর ১০ অনুচ্ছেদ অনুযায়ী ব্যবসা, রুটি, পেশা বা শিল্প প্রতিষ্ঠানের উপর আরোপিত কর আদায়ের লক্ষ্যে শিল্প/বণিক/প্রতিষ্ঠানের আনুকূলে অত্র ট্রেড লাইসেন্সটি ইস্যু করা হলো।

১। ব্যবসা প্রতিষ্ঠানের নাম	:	রুবাট স্টিল বিল্ডিং টেকনোলজি লি:		
২। প্রতিষ্ঠানের মালিকের নাম	:	মোঃ মীর হোসাইন (চেয়ারম্যান)		
৩। পিতা / স্বামীর নাম	:	অ. মাহান পাটোয়ারী		
৪। মাতার নাম	:	সুফিয়া বেগম		
৫। ব্যবসার প্রকৃতি	:	লিমিটেড কোম্পানী		
৬। ব্যবসার ধরণ	:	প্রথম শ্রেণীর ঠিকাদার		
৭। প্রতিষ্ঠানের ঠিকানা	:	৫৫ বি পুরানা পল্টন, নোয়াখালী টাওয়ার ১৪বি, ঢাকা-১০০০		
৮। অঞ্চল / বাজার শাখা	:	২	ওয়ার্ড / মার্কেট: ১০	
এলাকা	:	-		
৯। এনআইডি/পাসপোর্ট/জন্ম নিব: নং	:	2694814914423	বিআইএন নং:	
ফোন	:	01858444666	ই-মেইল:	
১০। অর্থ বছর	:	২০২০-২০২৪ (নবায়নকৃত)	ব্যবসা শুরু তারিখ: ০১/০৭/২০১৯	
১১। মালিকের বর্তমান ঠিকানা	:	৪, সার্কিট হাউজ, স্ল্যাট ২/জে হোল্ডিং নং	মালিকের স্থায়ী ঠিকানা	
হোল্ডিং নং	:			
রোড নং	:			
গ্রাম / মহল্লা	:		মালীগাঁও	
পোস্টকোড	:		কশিখপুর	
ধনা	:	রমনা	হাজীগঞ্জ	
জেলা	:	ঢাকা	চাঁদপুর	
বিভাগ	:	ঢাকা		
১২। ট্রেড লাইসেন্স/নবায়ন ফি (বার্ষিক)	:			
লাইসেন্স/নবায়ন ফি	:	২০০০	সাইনবোর্ড ফর	৪৮০
সারচার্জ	:	০	ভাট	৩৭২
আয়কর / উৎসেধক	:	৩০০০	ফর্ম ফি	৫০
বকেয়া ( )	:	০		
সংশোধনী ফি	:	০.০০	সর্বমোট	৫৯০২.০০

অত্র ট্রেড লাইসেন্স এর মেয়াদ ৩০ শে জুন, ২০২৪ পর্যন্ত

লাইসেন্স ও বিজ্ঞাপন সুপারভাইজার



কর কর্মকর্তা



**Government of the People's Republic of Bangladesh**

**National Board of Revenue**

**Taxpayer's Identification Number (TIN) Certificate**

**TIN : 165016373933**

This is to Certify that **Robust Steel Building Technology Limited** is a Registered Taxpayer of National Board of Revenue under the jurisdiction of **Taxes Circle-112 (Company)** , Taxes Zone **06, Dhaka**.

**Taxpayer's Particulars :**

- 1) Name : **Robust Steel Building Technology Limited**
- 2) Registered Address/Permanent Address : **55/B, NOAKHALI TOWER, Paltan, Dhaka, PO : 1000**
- 3) Current Address :
- 4) Previous TIN : **Not Applicable**
- 5) Status : **Company**

Date : October 20, 2019

**Please Note:**

1. A Taxpayer is liable to file the Return of Income under section 75 of the Income Tax Ordinance, 1984.
2. Failure to file Return of Income under section 75 is liable to-
  - (a) Penalty under section 124; and
  - (b) Prosecution under section 164 of the Income Tax Ordinance, 1984.



**Deputy Commissioner of Taxes**  
Taxes Circle-112 (Company)  
Taxes Zone 06, Dhaka  
Address : 209/A-B, Shahid Syed Nazrul Islam Sarani,  
Purana Paltan, Dhaka Phone : 55112415

N. B: This is a system generated certificate and requires no manual signature.



**Government of the People's Republic of Bangladesh  
National Board of Revenue**

Mushak-2.3

Customs, Excise and VAT Commissionerate, Dhaka (North)  
Gulshan Division

**Value Added Tax Registration Certificate**

This is to certify that the person whose details are given below is registered under  
Value Added Tax and Supplementary Duty Act, 2012 (Act No. 47 of 2012)

**BIN : 003639345-0101**

Name of the Entity	: ROBUST STEEL BUILDING TECHNOLOGY LIMITED
Trading Brand Name	: Robust Steel Building Technology Ltd.
Old BIN	: N/A
e-TIN	: 165016373933
Address	: Flat# A-4, House#24, Road#01, Block#B, Niketan, Gulshan-01,Dhaka-1212.; Gulshan PS; Dhaka - 1212;Ban Gulshan PS; Dhaka-1212; Bangladesh
Issue Date	: 10/03/2021
Effective Date	: 10/03/2021
Type of Ownership	: Private Limited
Major Area of Economic Activity	: Services

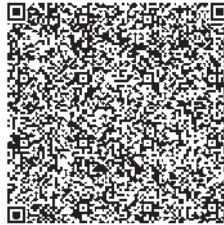

*This is a system generated certificate and doesn't require any signature*

ঠিকাদার/প্রতিষ্ঠানের নাম : রুবায়ত ফিল্ম রিভিউ  
 বিন্দু টেলিকমিউনিকেশনস লিমিটেড  
 আইডি নং : DHK-0187



নমুনা স্বাক্ষর : [Signature]

প্রতিষ্ঠানের নাম : রুবায়ত ফিল্ম রিভিউ  
 ট্রেড লাইসেন্স নং : TRAD/DS/E/238372/2019  
 টিআইএন নং : 165016373933  
 ভ্যাট রেজি. নং :  
 ঠিকাদারের নাম : শ্রীঃ মীর হোসাইন হোসেন  
 পিতার নাম : শ্রীঃ মোঃ মাদান মার্তোয়ারী  
 মাতার নাম : শ্রীঃ মুমিনাতুন্না বেগম  
 স্থায়ী ঠিকানা : চাম্পীগাতি  
 গ্রাম/ওয়ার্ড :  
 ডাকঘর : বগনিয়াপুর  
 উপজেলা/পৌরসভা : হাজিগঞ্জ  
 জেলা : চাঁদপুর  
 টেলিফোন নং :

স্বাক্ষর : [Signature]  
 মালিক/ব্যবসায়িক অংশীদার/  
 ব্যবস্থাপনা পরিচালকের স্বাক্ষর

জন্ম তারিখ : ১৯/০২/১৯৮০ স্বাক্ষর নং-  
 প্রকৌশলী, ১ এলজিইডি'র  
 এলজিইডি/পিইসিঃ ৪৬,০২,০৮৮০, ৩৫০-১১,০০০,  
 তারিখ : ১৯/০২/২২ ইং মোতাবেক  
 প্রদত্ত অনুমোদনের প্রেক্ষিতে জনাব/মেসার্স  
রুবায়ত ফিল্ম রিভিউ টেলিকমিউনিকেশনস  
লিমিটেড জরুরী জেলার ঠিকাদার/  
 ঠিকাদারী প্রতিষ্ঠান হিসাবে তালিকাভুক্ত করা  
 হলো। স্থানীয় সরকার প্রকৌশল অধিদপ্তরের অত্র  
 অঞ্চলের আওতাধীন জেলা ও উপজেলায় সীমিত  
 দরপত্র পদ্ধতির মাধ্যমে বাস্তবায়িতব্য উন্নয়নমূলক  
 কাজের (কার্য) দরপত্রে অংশগ্রহণ করা যাবে।

নির্বাহী প্রকৌশলী  
 স্থানীয় সরকার প্রকৌশল অধিদপ্তর  
 জেলা : চাঁদপুর  
১৫/০২/২২



# ROBUST STEEL BUILDING TECHNOLOGY LTD.

A Pre-Engineered Steel Building Manufacturer

Head Office: House 24 (Flat: A-3), Block-B, Road-01, Niketan, Gulshan-01, Dhaka-1212.

Factory : Shaha Beliswar, Bathuli, Dhamrai, Dhaka.

☎ +8801773 421 821, 01858 444 666 ✉ E-mail : [robuststeel.bd@gmail.com](mailto:robuststeel.bd@gmail.com)

📘 Robust Steel Building Technology Ltd.

🌐 web: [www.robuststeelbd.com](http://www.robuststeelbd.com)

